

Studio Tiny House

The Studio Tiny House is a study in spatial optimization and architectural efficiency. By pairing a high ceiling with an open concept layout, we've created a 170-square-foot interior that feels expansive rather than confined. The clean, modern aesthetic with the ease of use and ample storage make this a home worth experiencing. It is a high-performance build that is intended to serve as an ADU, luxury guest suite, or cozy primary residence.

\$75,000 (as shown)



Highlights



Storage



Studio Design



Turn-Key

Thoughtfully integrated storage including a dedicated bathroom closet, built-in shelving, and ample kitchen cabinetry.

An open-concept layout featuring high ceilings and large black aluminum windows that create an airy, expansive interior far beyond its footprint.

Completely "plug-in ready" with all utilities, furniture, and appliances installed and ready for your (our your guest's) comfort.

170 Sqft Total

20ft Long

25ft Trailer

8.5ft Wide

12ft Tall

Est. Weight

9k-10k lbs

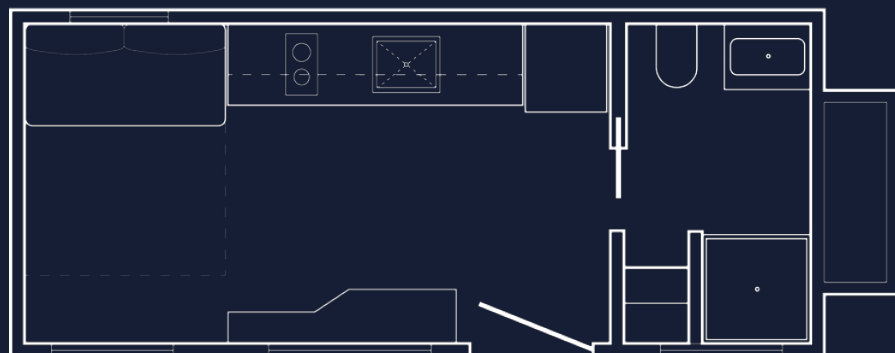

2026 Studio Tiny House

Technical Specifications

Overview & Compliance

Certification: IRC and ANSI via NOAH RDI

Compliance: Fire Sprinkler Equipped (San Diego County Primary Dwelling Compliant),
Non-Combustible Siding (WUI approved)

Financing: Options available

Detailed Specifications

1. FOUNDATION & STRUCTURAL ENGINEERING

Trailer: Iron Eagle PAD Series (Industry-leading THOW foundation)

Construction: 100% tube steel, fully welded.

Complete Thermal Break: No direct contact between trailer steel and framing elements.
All mounting bolts are foamed to prevent condensation and heat transfer.

Insulation: Rockwool (fire resistant and sound abatement); Floor: R-25, Walls: R-15, Ceiling: R-30

2. EXTERIOR & BUILDING ENVELOPE

Siding: Steel with cedar accent walls; option for Cedar Open-Jointed Cladding (shown).

Roofing: Steel, 24ga PBR panel.

Windows: Aluminum frames; tempered glass, double-paned, and argon-filled.

Entry Door: Solid mahogany with low-e tempered glass.

Utility Bump-Out: Housing for mechanical systems to preserve architectural lines.

3. SYSTEMS & UTILITIES

Fire Safety: Fully integrated residential fire sprinkler system.

Climate Control: 10,000 BTU mini-split, 20.8 SEER2.

Electrical: 50amp main with, 20 amp circuits. USB Type A and Type C charging outlets.

Water Heating: Rinnai tankless LP water heater (exterior).

Ventilation: Externally vented range hood and humidistat-controlled bathroom exhaust.

4. INTERIOR FINISHES & FURNISHINGS

Walls & Ceiling: Natural cedar throughout.

Flooring: Engineered hardwood maple; scratch and water resistant.

Doors: Solid white oak pocket door (bathroom).

Surfaces: Custom shelving crafted from Baltic Birch.

Living Area: Sofa/sleeper, pulls out to a queen sized bed.

Integrated shelving and table/desk workstation.

Kitchen: Workstation sink, two-burner induction cooktop, fridge/freezer

Bathroom: 32" acrylic shower with rainfall head and wand, vanity sink with LED mirror,
European-style flush toilet, stacked washer and dryer unit.